

2
BED

Rarely Available Garden Apartment

41, Roundhouse Crescent, Peacehaven, BN10 8GL



Price £230,000

Leasehold - Share of Freehold

phillipmann
we do more

www.phillipmann.com

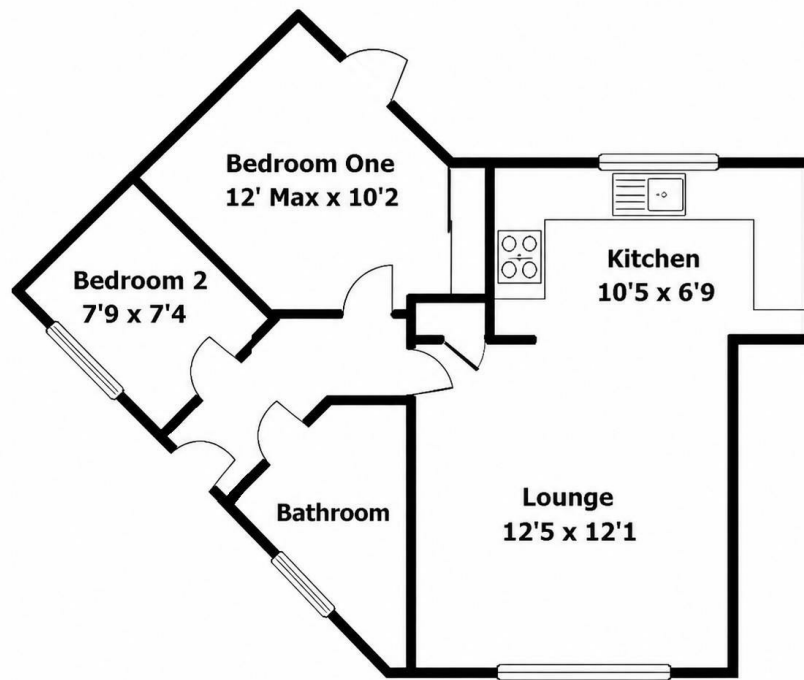

inbrief...

This well-presented ground floor garden apartment is ideally located in the heart of Peacehaven, offering low outgoings and broad appeal for first-time buyers and investors alike.

The property is within easy walking distance of Centenary Park, local shops, schools, regular bus routes, the cliff top promenade, and beach access—making it a convenient and desirable location.

Internally, the apartment is tastefully decorated in neutral tones with modern flooring throughout, creating a bright and comfortable living space. Natural light is a key feature, enhanced by the property's favourable orientation.

The accommodation is arranged around a central hallway, providing access to all principal rooms. The south-facing open-plan lounge offers ample space for seating and dining, while the adjoining kitchen is well-equipped with generous worktop space and integrated appliances. A rear window overlooks the private garden.

There are two bedrooms, including a main bedroom with built-in wardrobes and French doors opening directly onto the garden. The second bedroom is also well-proportioned and positioned to the front.

The bathroom is modern in design and benefits from a window for natural light and ventilation.

Externally, the property features a private, level rear garden—ideal for relaxing or entertaining. A rear gate leads to a small parking area, where the property has an allocated space.

The property is further enhanced by a share of the freehold, a long lease, and low ongoing costs.

Remainder of 999 Year Lease
Share of Freehold
50% of all agreed Outgoings
50% of Building Insurance



EPC Rating - C
Council Tax Band - B

moreinfo...



Phillip Mann Peacehaven Office
226-230 South Coast Road, Peacehaven, BN10 8JR
01273 586622

To see more details on this & all our homes go to
www.phillipmann.com